

Snap Product Factsheet



Note Design Studio

The Snap lounge chair is the result of a collaboration between designers from Note Design Studio and engineers at Profim. While Profim integrates cutting-edge engineering solutions to ensure durability and functionality, Note Design Studio infuses the lounge chair with a design language that caters to the unique needs of workplaces and public spaces, prioritizing the wellbeing of both employees and customers. Together, we are not just creating furniture; we are setting a new benchmark for what modern products can and should be.



Snap collection

Snap. Let's sit and talk.

- Snap lounge chair epitomizes comfort and style, designed to maximize user comfort.
- Snap collection offers two distinct aesthetics: the softer and more expressive *fluffy* (21H) and delicate *slim* (20H).
- Designed to support the body and promote well-being in the workplace, Snap enhances employee productivity.
- Created with sustainability in mind, Snap employs innovative technologies and environmentally friendly materials, minimizing the negative impact on the planet while maintaining high quality and durability.
- Snap is certified by the EU Ecolabel, Möbelfakta, Greenguard, and EPD.
- The seat is composed of up to 75% recycled polypropylene, while the back is made of up to 70% recycled polyamide. The carbon footprint of the *slim* 20H version is 49,4 kg, and the *fluffy* 21H version is 53,3 kg.

Quality

Profim provides a 5-year warranty for products used 8 hours a day, 5 days a week (single shift operation).

Certificates



Technical data

Backrest and seat:

- Fully upholstered (without the use of metal staples nor glue).
- Construction made of polypropylene with 75% recycled content (backrest).
- Construction made of polyamide with 70% recycled content (seat).
- With inner pad filled with 100% recycled polyester fibers (version 21H).
- Moulded foam, density 65kg/m³.

Armrests:

- Optional, as integral element of the metal frame.
- Optional upholstered armrest cover in Snap 21H (*fluffy*), with inner pad filled with 100% recycled polyester fibers.

Frame:

- Metal tube with a diameter of Ø25mm and thickness of 2mm.
- Metal profile 50x20mm, thickness of 2mm.

Glides:

- Teflon glides - universal (set).
- Felt glides - for hard floors (set).

Versions



20H (*Slim*)



21H (*Fluffy*)

Armrests



Without



2P
Metal armrests



2PF¹
Metal armrests with
upholstered covers

Glides colour²



Black

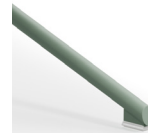

White

Frame colours



White
RAL 9016



Light Grey
NCS S 2500-N



Grey
NCS S 6500-N



Black
RAL 9005



Deep Green
RAL 6004



Navy Blue
RAL 5003



Burgundy
RAL 3005



Salvia/Green
RAL 6021



Blue
RAL 5014



Terracotta
RAL 3012



MetallicPro



Metasilver

¹ Available only in a *fluffy* version (Snap 21H).
² Glides colour matched to frame colour.

Dimensions

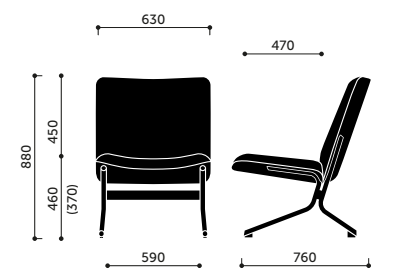

20H

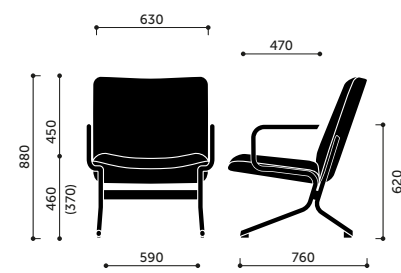

20H 2P

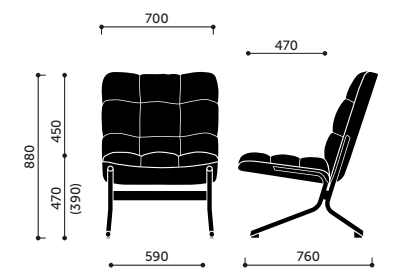

21H

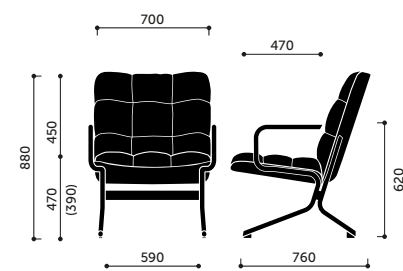

21H 2P

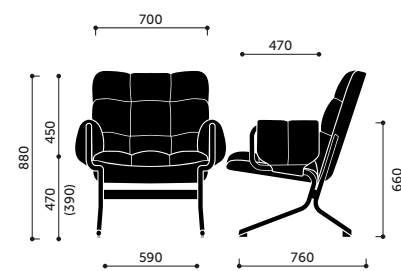

21H 2PF